

Spacer tube steel

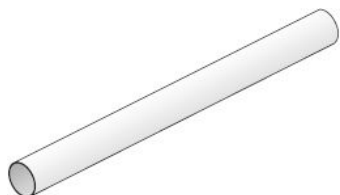

Steel spacer tubes are recommended especially for thick walls and, with welded-on water stops, at groundwater level. Wassersperren.

Article description	Title of variant	Shutter	Ø internal mm	Ø external mm	Packaging piece/ metre/ metre by the metre/ bucket/ bag/ bundle/ box/ can	Weight kg/metre
62022000	Dist St-22, bearing length 2,00 m	FLUPP® 22 St	24,800	26	50 metres/bunch	0,378
62022150	Dist St-22, blanks	FLUPP® 22 St	24,800	26		0,378
61822381	SD-Ring seal				1 piece	0,017
61822400	SD-Assembly pliers				1 piece	0,313