

## Exposed concrete plug for MKK® Cone EX-WU

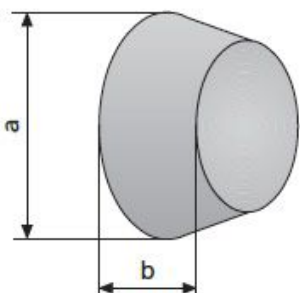

For closing conical holes. Bonded in with two-component adhesive. 1 kg of adhesive is sufficient for approx. 40 B15 plugs.

Article description	Title of variant	a mm	b mm	Packaging piece/ metre/ metre by the metre/ bucket/ bag/ bundle/ box/ can	Weight kg/piece
18392015	BETOMAX® 15	60	49	75 pieces	0,228
14392020	BETOMAX® 20	67	50	60 pieces	0,285
21393000	BETOMAX® 26,5	101	65	20 pieces	0,889