

Type WH - angle with hook in sheet direction - Type WH 2-row - double angle with hook in sheet direction

Typ WH - 2reihig Doppelwinkel mit Haken in Blechrichtung

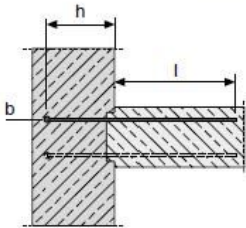

Typ WH Winkel mit Haken in Blechrichtung

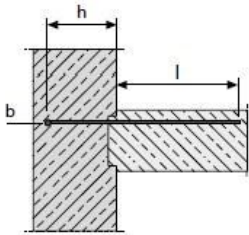

Type WH / WH 2-row

Angle with hooks in sheet direction, double-section as double angle (- hooks) also available with different steel diameters.

Technical data

The values e , b , h and l are variable depending on the element width, sheet type and BSt \emptyset . The anchoring length applies only to single-row elements with standard perforation.

Subject to technical changes. The dimensions as well as the combination of the maximum values must be agreed in each individual case.

Listed are design examples.

Type WH - angle with hook in sheet direction - Type WH 2-row - double angle with hook in sheet direction

Element width mm	Sheet type P	BSt Ø mm	Bracket spacing e in cm	Bracket spacing b in cm	Bracket height h in cm	Anchoring length for element length 83 cm l in cm	Anchoring length for panel length 125 cm l in cm
60	P	8	10			max. 41	max. 41
60	P	8	15			max. 45	max. 67
60	P	8	20	8	8 - 98	max. 49	max. 69
60	P	10	10	8	10 - 98	max. 31	max. 31
60	P	10	15	8	10 - 98	max. 44	max. 46
60	P	10	20	8	10 - 98	max. 48	max. 58
60	P	12	10	8	12 - 98	max. 23	max. 23
60	P	12	15	8	12 - 98	max. 35	max. 35
60	P	12	20	8	12 - 98	max. 48	max. 51
80	P	8	10	8	8 - 98	max. 43	max. 64
80	P	8	15	8	8 - 98	max. 45	max. 67
80	P	8	20	8	8 - 98	max. 49	max. 70
80	P	10	10	8	10 - 98	max. 42	max. 45
80	P	10	15	8	10 - 98	max. 45	max. 65
80	P	10	20	8	10 - 98	max. 47	max. 68
80	P	12	10	8	12 - 98	max. 38	max. 38
80	P	12	15	8	12 - 98	max. 42	max. 58
80	P	12	20	8	12 - 98	max. 48	max. 67
110	P/Q/L	8	10	8	8 - 98	max. 44	max. 64
110	P/Q/L	8	15	8	8 - 98	max. 46	max. 67
110	P/Q/L	8	20	8	8 - 98	max. 49	max. 70
110	P/Q/L	10	10	8	10 - 98	max. 43	max. 63
110	P/Q/L	10	15	8	10 - 98	max. 44	max. 66
110	P/Q/L	10	20	8	10 - 98	max. 48	max. 69
110	P/Q/L	12	10	8	12 - 98	max. 43	max. 62
110	P/Q/L	12	15	8	12 - 98	max. 44	max. 66
110	P/Q/L	12	20	8	12 - 98	max. 48	max. 69