

Type B - Wide connection, plug-in bracket in 2 sheets

Typ B
*Breiter Anschluss,
Steckbügel in 2 Blechen*

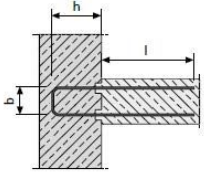

Type B

Wide connection, plug-in bracket in 2 sheets.

Technical data

The values e , b , h and l are variable depending on element width, sheet type and BSt \emptyset . Other stirrup widths on request.

Subject to technical changes. The dimensions and the combination of the maximum values must be agreed in each individual case. Listed are design examples.

Type B - Wide connection, plug-in bracket in 2 sheets

Element width mm	Sheet type P	BSt Ø mm	Bracket spacing e in cm	Bracket spacing b in cm	Bracket height h in cm	Anchoring length for element length 83 cm l in cm	Anchoring length for panel length 125 cm l in cm
60	P	8	10			7 - 41	7 - 41
60	P	8	15	12	8 - 98	7 - 45	7 - 67
60	P	8	20	12	8 - 98	7 - 49	7 - 69
60	P	10	10	12	10 - 98	9 - 31	9 - 31
60	P	10	15	12	10 - 98	9 - 44	9 - 46
60	P	10	20	12	10 - 98	9 - 48	9 - 58
80	P	8	10	16	8 - 98	7 - 43	7 - 64
80	P	8	15	16	8 - 98	7 - 45	7 - 67
80	P	8	20	16	8 - 98	7 - 49	7 - 70
80	P	10	10	16	10 - 98	9 - 42	9 - 45
80	P	10	15	16	10 - 98	9 - 45	9 - 65
80	P	10	20	16	10 - 98	9 - 47	9 - 68
80	P	12	10	16	12 - 98	10 - 40	11 - 38
80	P	12	15	16	12 - 98	11 - 42	11 - 58
80	P	12	20	16	12 - 98	11 - 48	11 - 67
110	P/Q/L	8	10	22	8 - 98	7 - 44	7 - 64
110	P/Q/L	8	15	22	8 - 98	7 - 46	7 - 67
110	P/Q/L	8	20	22	8 - 98	7 - 49	7 - 70
110	P/Q/L	10	10	22	10 - 98	9 - 43	9 - 63
110	P/Q/L	10	15	22	10 - 98	9 - 44	9 - 66
110	P/Q/L	10	20	22	10 - 98	9 - 48	9 - 69
110	P/Q/L	12	10	22	12 - 98	11 - 43	11 - 62
110	P/Q/L	12	15	22	12 - 98	11 - 44	11 - 66
110	P/Q/L	12	20	22	12 - 98	11 - 48	11 - 69
140	P/Q/L	8	10	28	8 - 98	7 - 44	7 - 65
140	P/Q/L	8	15	28	8 - 98	7 - 47	7 - 68
140	P/Q/L	8	20	28	8 - 98	7 - 50	7 - 70
140	P/Q/L	10	10	28	10 - 98	9 - 43	9 - 64
140	P/Q/L	10	15	28	10 - 98	9 - 46	9 - 67
140	P/Q/L	10	20	28	10 - 98	9 - 49	9 - 69
140	P/Q/L	12	10	28	12 - 98	11 - 43	11 - 64
140	P/Q/L	12	15	28	12 - 98	11 - 46	11 - 67
140	P/Q/L	12	20	28	12 - 98	11 - 49	11 - 69
160	P/Q/L	8	10	32	8 - 98	7 - 45	7 - 66
160	P/Q/L	8	15	32	8 - 98	7 - 47	7 - 68
160	P/Q/L	8	20	32	8 - 98	7 - 50	7 - 71

Type B - Wide connection, plug-in bracket in 2 sheets

Element width mm	Sheet type P	BSt Ø mm	Bracket spacing e in cm	Bracket spacing b in cm	Bracket height h in cm	Anchoring length for element length 83 cm l in cm	Anchoring length for panel length 125 cm l in cm
160	P/Q/L	10	10	32	10 - 98	9 - 43	9 - 64
160	P/Q/L	10	15	32	10 - 98	9 - 46	9 - 67
160	P/Q/L	10	20	32	10 - 98	9 - 49	9 - 70
160	P/Q/L	12	10	32	12 - 98	11 - 43	11 - 64
160	P/Q/L	12	15	32	12 - 98	11 - 46	11 - 67
160	P/Q/L	12	20	32	12 - 98	11 - 49	11 - 70
190	P/Q/L	8	10	38	8 - 98	7 - 46	7 - 66
190	P/Q/L	8	15	38	8 - 98	7 - 48	7 - 68
190	P/Q/L	8	20	38	8 - 98	7 - 51	7 - 71
190	P/Q/L	10	10	38	10 - 98	9 - 45	9 - 65
190	P/Q/L	10	15	38	10 - 98	9 - 47	9 - 68
190	P/Q/L	10	20	38	10 - 98	9 - 50	9 - 70
190	P/Q/L	12	10	38	12 - 98	11 - 44	11 - 65
190	P/Q/L	12	15	38	12 - 98	11 - 47	11 - 68
190	P/Q/L	12	20	38	12 - 98	11 - 50	11 - 70
220	P/Q/L	8	10	44	8 - 98	7 - 47	7 - 68
220	P/Q/L	8	15	44	8 - 98	7 - 49	7 - 70
220	P/Q/L	8	20	44	8 - 98	7 - 53	7 - 72
220	P/Q/L	10	10	44	10 - 98	9 - 46	9 - 66
220	P/Q/L	10	15	44	10 - 98	9 - 48	9 - 69
220	P/Q/L	10	20	44	10 - 98	9 - 52	9 - 71
220	P/Q/L	12	10	44	12 - 98	11 - 46	11 - 65
220	P/Q/L	12	15	44	12 - 98	11 - 48	11 - 69
220	P/Q/L	12	20	44	12 - 98	11 - 52	11 - 71
240	P/Q/L	8	10	48	8 - 98	7 - 47	7 - 68
240	P/Q/L	8	15	48	8 - 98	7 - 49	7 - 70
240	P/Q/L	8	20	48	8 - 98	7 - 53	7 - 72
240	P/Q/L	10	10	48	10 - 98	9 - 46	9 - 66
240	P/Q/L	10	15	48	10 - 98	9 - 48	9 - 69
240	P/Q/L	10	20	48	10 - 98	9 - 52	9 - 71
240	P/Q/L	12	10	48	12 - 98	11 - 46	11 - 65
240	P/Q/L	12	15	48	12 - 98	11 - 48	11 - 69
240	P/Q/L	12	20			11 - 52	11 - 71