

Type KHS - bracket type for wide cantilever brackets with suitable plug-in bracket

Typ KHS

Konsoltyp für weit auskragende Konsolen mit passendem Steckbügel.

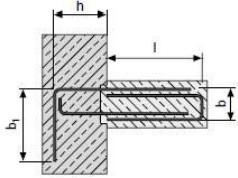

Type KHS

Bracket type for wide cantilever brackets with matching plug-in bracket.

The plug-in bracket is supplied and must be bent after bending.

Technical data

The values e , b , b_1 , h and l are variable depending on element width, sheet type and BSt \emptyset .

We reserve the right to make technical changes. The dimensions and the combination of the maximum values must be agreed in each individual case. Listed are design examples.

Type KHS - bracket type for wide cantilever brackets with suitable plug-in bracket

Element width mm	Sheet type P	BSt Ø mm	Bracket spacing e in cm	Bracket spacing b in cm	Bracket height h in cm	Anchoring length for element length 83 cm l in cm	Anchoring length for panel length 125 cm l in cm
80	P	8	10	6	8 - 98	max. 20	max. 20
80	P	8	15	6	8 - 98	max. 31	max. 31
80	P	8	20	6	8 - 98	max. 41,5	max. 42
80	P	10	10	6	10 - 98	max. 14	max. 14
80	P	10	15	6	10 - 98	max. 23	max. 23
80	P	10	20	6	10 - 98	max. 31	max. 31
110	P/Q/L	8	10	8	8 - 98	max. 30	max. 30
110	P/Q/L	8	15	8	8 - 98	max. 41,5	max. 46
110	P/Q/L	8	20	8	8 - 98	max. 41,5	max. 62
110	P/Q/L	10	10	8	10 - 98	max. 23	max. 23
110	P/Q/L	10	15	8	10 - 98	max. 35	max. 35
110	P/Q/L	10	20	8	10 - 98	max. 41,5	max. 48
110	P/Q/L	12	10	8	12 - 98	max. 18	max. 18
110	P/Q/L	12	15	8	12 - 98	max. 28	max. 28
110	P/Q/L	12	20	8	12 - 98	max. 38	max. 38
140	P/Q/L	8	10	11	8 - 98	max. 41,5	max. 45
140	P/Q/L	8	15	11	8 - 98	max. 41,5	max. 62,5
140	P/Q/L	8	20	11	8 - 98	max. 41,5	max. 62,5
140	P/Q/L	10	10	11	10 - 98	max. 35	max. 35
140	P/Q/L	10	15	11	10 - 98	max. 41,5	max. 54
140	P/Q/L	10	20	11	10 - 98	max. 41,5	max. 62,5
140	P/Q/L	12	10	11	12 - 98	max. 28	max. 28
140	P/Q/L	12	15	11	12 - 98	max. 41,5	max. 44
140	P/Q/L	12	20	11	12 - 98	max. 41,5	max. 59
160	P/Q/L	8	10	13	8 - 98	max. 41,5	max. 55
160	P/Q/L	8	15	13	8 - 98	max. 41,5	max. 62,5
160	P/Q/L	8	20	13	8 - 98	max. 41,5	max. 62,5
160	P/Q/L	10	10	13	10 - 98	max. 41,5	max. 44
160	P/Q/L	10	15	13	10 - 98	max. 41,5	max. 62,5
160	P/Q/L	10	20	13	10 - 98	max. 41,5	max. 62,5
160	P/Q/L	12	10	13	12 - 98	max. 36	max. 36
160	P/Q/L	12	15	13	12 - 98	max. 41,5	max. 54
160	P/Q/L	12	20	13	12 - 98	max. 41,5	max. 62,5
190	P/Q/L	8	10	16	8 - 98	max. 41,5	max. 62,5
190	P/Q/L	8	15	16	8 - 98	max. 41,5	max. 62,5
190	P/Q/L	8	20	16	8 - 98	max. 41,5	max. 62,5

Type KHS - bracket type for wide cantilever brackets with suitable plug-in bracket

Element width mm	Sheet type P	BSt Ø mm	Bracket spacing e in cm	Bracket spacing b in cm	Bracket height h in cm	Anchoring length for element length 83 cm l in cm	Anchoring length for panel length 125 cm l in cm
190	P/Q/L	10	10	16	10 - 98	max. 41,5	max. 56
190	P/Q/L	10	15	16	10 - 98	max. 41,5	max. 62,5
190	P/Q/L	10	20	16	10 - 98	max. 41,5	max. 62,5
190	P/Q/L	12	10	16	12 - 98	max. 41,5	max. 46
190	P/Q/L	12	15	16	12 - 98	max. 41,5	max. 62,5
190	P/Q/L	12	20	16	12 - 98	max. 41,5	max. 62,5
220	P/Q/L	8	10	19	8 - 98	max. 41,5	max. 62,5
220	P/Q/L	8	15	19	8 - 98	max. 41,5	max. 62,5
220	P/Q/L	8	20	19	8 - 98	max. 41,5	max. 62,5
220	P/Q/L	10	10	19	10 - 98	max. 41,5	max. 62,5
220	P/Q/L	10	15	19	10 - 98	max. 41,5	max. 62,5
220	P/Q/L	10	20	19	10 - 98	max. 41,5	max. 62,5
220	P/Q/L	12	10	19	12 - 98	max. 41,5	max. 57
220	P/Q/L	12	15	19	12 - 98	max. 41,5	max. 62,5
220	P/Q/L	12	20	19	12 - 98	max. 41,5	max. 62,5
240	P/Q/L	8	10	21	8 - 98	max. 41,5	max. 62,5
240	P/Q/L	8	15	21	8 - 98	max. 41,5	max. 62,5
240	P/Q/L	8	20	21	8 - 98	max. 41,5	max. 62,5
240	P/Q/L	10	10	21	10 - 98	max. 41,5	max. 62,5
240	P/Q/L	10	15	21	10 - 98	max. 41,5	max. 62,5
240	P/Q/L	10	20	21	10 - 98	max. 41,5	max. 62,5
240	P/Q/L	12	10	21	12 - 98	max. 41,5	max. 62,5
240	P/Q/L	12	15	21	12 - 98	max. 41,5	max. 62,5
240	P/Q/L	12	20	21	12 - 98	max. 41,5	max. 62,5